

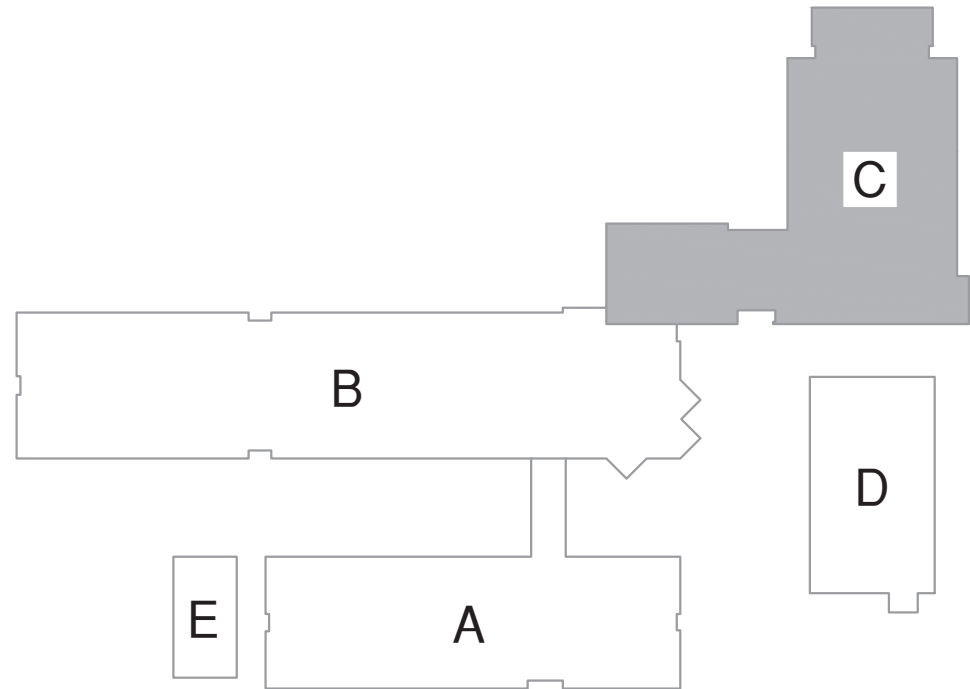

— EXISTING TO BE REPLACED WITH NEW.
~~—X—X—X~~ EXISTING TO BE REMOVED.

- (E1) DISCONNECT AND REMOVE ALL EXISTING LIGHTING FIXTURES. LEGALLY DISPOSE ALL LAMPS AND BALLAST. PROVIDE NEW FIXTURE IN SAME LOCATION. CONNECT TO EXISTING LIGHTING CIRCUIT/WHIP UNLESS NOTED OTHERWISE.
- (E2) ALL EXIT AND EMERGENCY LIGHTING FIXTURES SHALL REMAIN AND ARE NOT INDICATED ON PLAN (UNLESS SPECIFICALLY NOTED ON PLAN TO BE REPLACED).
- (E3) ALL 2X4 LIGHTING FIXTURES INSTALLED IN CEILING GRID SHALL BE INDEPENDENTLY SUPPORTED FROM STRUCTURE.
- (E4) DISCONNECT AND REMOVE EXISTING LINEAR FIXTURES AND REPLACE WITH NEW AT SAME HEIGHT. CONNECT TO EXISTING CIRCUIT.
- (E5) DISCONNECT AND REMOVE EXISTING RECESSED FIXTURE. INSTALL NEW RECESS MOUNTED FIXTURE COMPLETELY COVERING EXISTING OPENING. EXTEND CONDUCTORS TO NEW FIXTURE. PROVIDE CUSTOM TRIM OR MODIFY OPENING AS REQUIRED.
- (E6) REPLACE ANY DAMAGED LAY IN CEILING TILES DUE TO NEW FIXTURE INSTALLATION. NEW TILES SHALL MATCH EXISTING; COORDINATE WITH OWNER.
- (E7) DISCONNECT AND REMOVE EXISTING LIGHT FIXTURE, CONDUITS, AND CONDUCTORS TO SOURCE. REPAIR CIRCUIT FOR CONTINUED OPERATION AS REQUIRED.



KEY PLAN

E4	FLOOR PLAN - AREA C - ELECTRICAL
1' = 1'-0"	

$$1/8'' = 1'-0''$$

PROJECT NO:
DRAWN:
CHECKED:
DATE:
LAST REV:

RT
RW
08.08.25

PHASE 2 - RENOVATIONS TO
CARTER C. RAYMOND
JUNIOR HIGH SCHOOL
2510 SAINT CHARLES AVE. LE COMPTÉ, LA 71301

EMA
DESIGN SOLVE ENHANCES

EMA Engineering & Consulting, INC.
9441 STEVENS ROAD, SUITE 200
SHREVEPORT, LOUISIANA 71106
318.425.4500
LOUISIANA Registered Engineering Firm #17-5818
TEXAS Registered Engineering Firm #1-983
5-200-2139-008

1439 Centre Ct., ste 401
Alexandria, LA 71301
Ph: 318.445.3151
Fx: 318.445.3988
Em: adga@adgllc.net

© 2006, Alliance Design Group, LLC all rights reserved